

BRASIL

MINISTÉRIO DA DEFESA – COMANDO DA AERONÁUTICA
DEPARTAMENTO DE CONTROLE DO ESPAÇO AÉREO
Av. General Justo, 160 – CEP 20021-130 – Rio de Janeiro/RJ
<http://www.decea.gov.br>

AIC
A
06/18
24 MAI 18

PUBLICATION OF INFORMATION REGARDING DISPLACED THRESHOLD DUE TO ROADWORK AT SBGL

Effective period: from 01 August to 30 November 2018

PRELIMINARY DISPOSITIONS

1.1 PURPOSE

- 1.1.1 This Aeronautical Information Circular has the purpose of informing airmen about the foreseen implications when restricting the use of RIO DE JANEIRO, RJ / GALEAO-ANTONIO CARLOS JOBIM (SBGL) Airport, which will be applied during roadwork on Runway 15/33, **from 01 August to 30 November 2018**. This AIC provides details on declared distances, visual aids and reference to the displaced thresholds to be used temporarily, which will enable the continuity of operation in both runways.
- 1.1.2 The publication of this AIC aims at providing support to charts ADC and IAC RNAV U RWY14, which will be published in AIP SUP-N114/A067 and AIP SUP-N113/A066.

1.2 SCOPE

- 1.2.1 The guidance provided in this Circular is applicable to:
- a) aircraft destined to or departing from SBGL, and the concerned units in the air operation control service at SBGL

1.3 DESCRIPTION

- 1.3.1 The need to extend the RESA (Safety Area at the end of the runway) for Runway 15/33 will bring changes to the runway dimensions, and result in the availability of a smaller segment for operation. With the purpose of distinguishing procedures for runway 15 in force, the identification of the new displaced threshold will be temporarily 14, therefore the new procedures will become effective for this runway.
- a) In the period from 01 August to 08 October 2018, the mentioned runway will measure 2,440 meters at first and will have identification 14/33, with the purpose of distinguishing procedures published for runway 15/33, according to Sketch Map Draft 01 and 02, and item 1.4.
 - b) In the period from 09 October to 30 November 2018, RESA will be adjusted for runway 33. The mentioned runway will measure 2,120 meters and the available declared distances will be shorter than the published for the current runway, according to Sketch Map 03 and 04, and item 1.4.

1.4 DECLARED DISTANCES

1.4.1 Period from 01 August 2018 to 08 October 2018.

RWY	TORA	ASDA	TODA	LDA
14	2440	2440	2440	2440
33	2440	2440	2440	2440

1.4.2 Period from 09 October 2018 to 30 November 2018

RWY	TORA	ASDA	TODA	LDA
15	2250	2250	2250	2120
33	2120	2120	2120	2120

1.5 VISUAL AIDS

According to NOTAM for that location.

1.6 PREFERENTIAL USE OF RUNWAYS

As prescribed by the ATC unit at SBGL.

2 FINAL DISPOSITIONS

2.1 The criteria and procedures established in this AIC do not excuse pilots and concerned units from complying with other dispositions prescribed in the legislation in force.

2.2 This AIC becomes effective before the commencement of the roadwork.

SKETCH 01



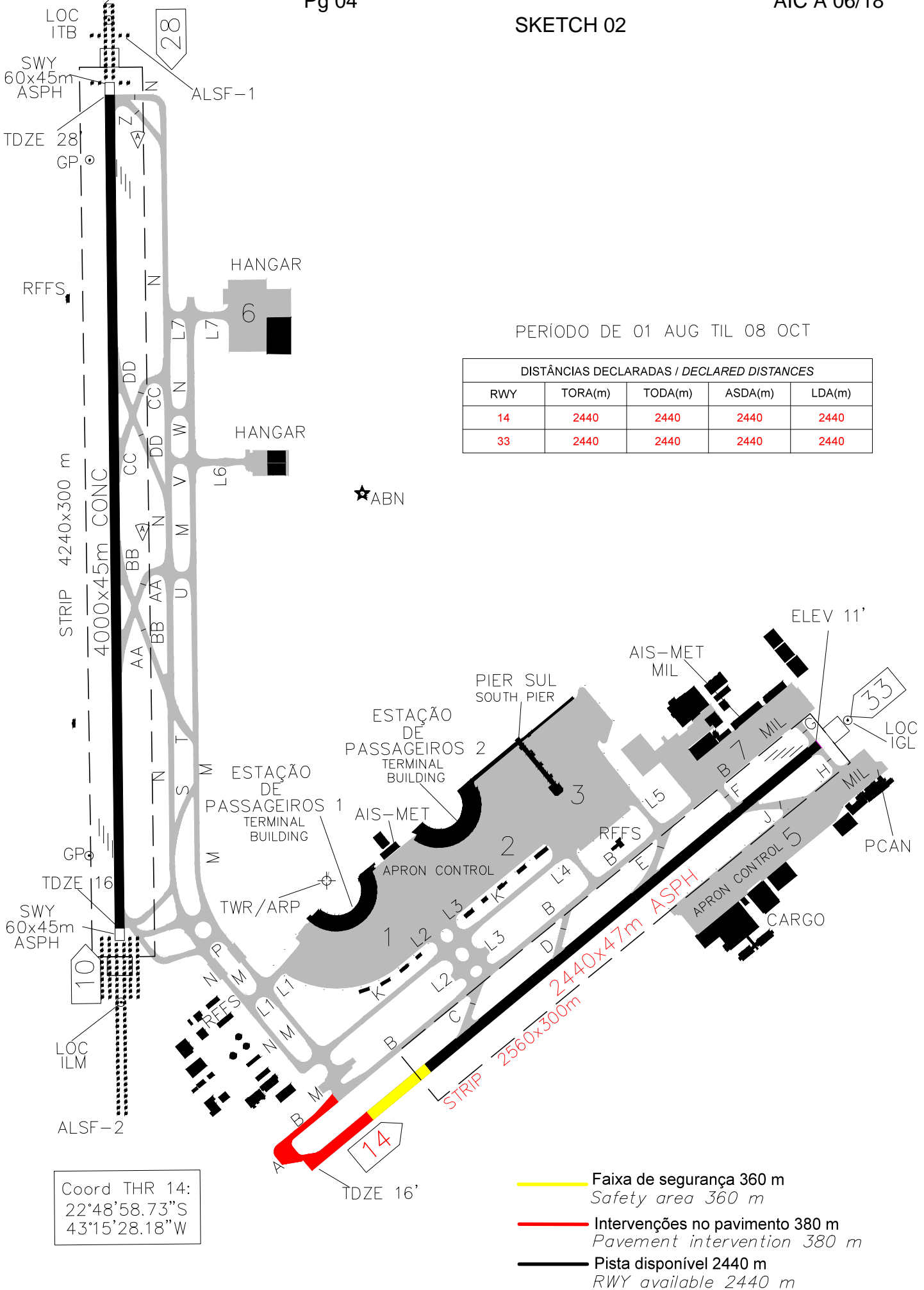

SKETCH 03



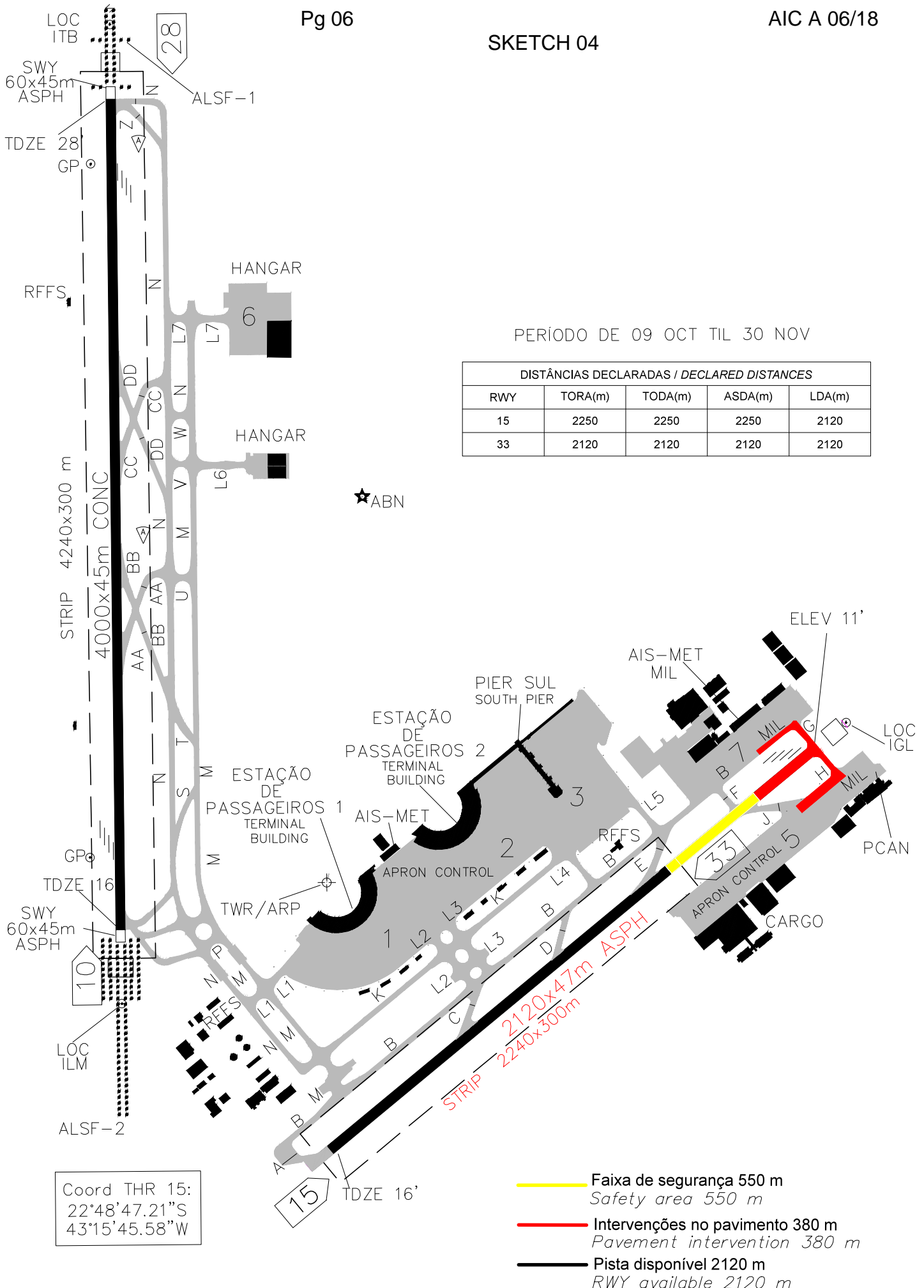

PERÍODO DE 09 OCT TIL 30 NOV

DISTÂNCIAS DECLARADAS / DECLARED DISTANCES				
RWY	TORA(m)	TODA(m)	ASDA(m)	LDA(m)
15	2250	2250	2250	2120
33	2120	2120	2120	2120

Coord THR 15:
22°48'47.21"S
43°15'45.58"W

- Faixa de segurança 550 m
Safety area 550 m
- Intervenções no pavimento 380 m
Pavement intervention 380 m
- Pista disponível 2120 m
RWY available 2120 m